

SYNDICAT INTERCOMMUNAL SCOLAIRE DE POURNOY LA GRASSE

CONSTRUCTION D'UN GROUPE SCOLAIRE A
POURNOY LA GRASSE

P H A S E D C E

C A R N E T D E D E T A I L S

M E N U I S E R I E S I N T E R I E U R E S

Novembre 2017

Maître d'ouvrage : Syndicat intercommunal scolaire de Pournoy-La-Grasse	Assistance à la Maîtrise d'Ouvrage : MATEC - Moselle Agence Technique 18, Boulevard Paixhans - 57000 METZ contact@matec57.fr 03 55 94 18 11	Details- Men.Int. Nov 2017	DETAIL-MI
Architectes Mandataires : Xavier Géant / Agnès Hausermann studiolada architectes 12, rue Saint Dizier - 54000 NANCY 03 83 33 92 13	Partenaires Maîtrise d'oeuvre : BET structure BARTHES Bois BET fluides Tecnos BET thermique Terranergie	studiolada a r c h i t e c t e s	

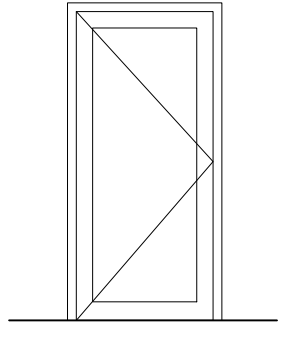
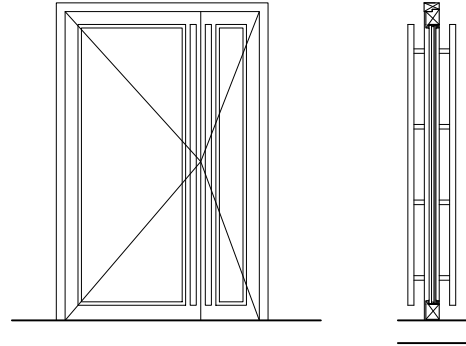
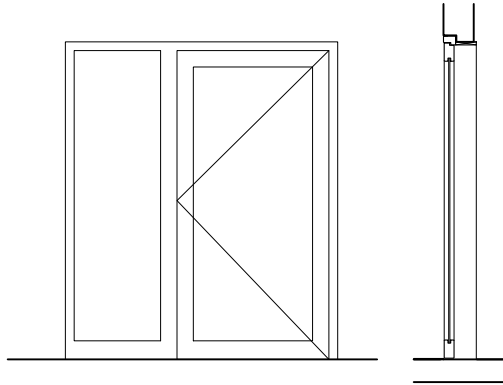
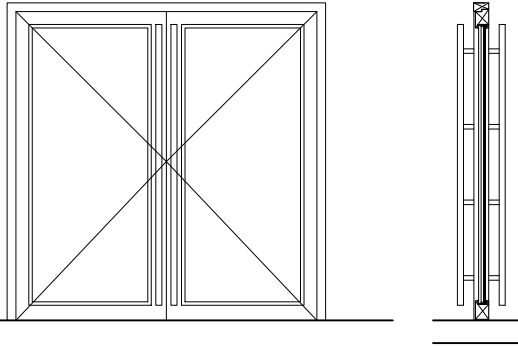
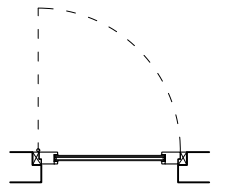
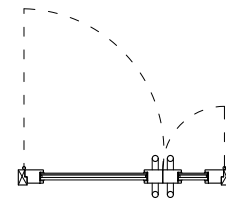
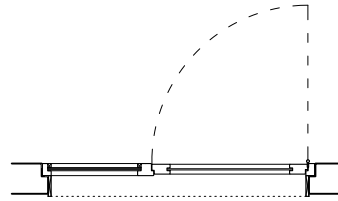
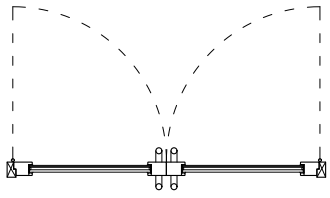

1.1 Portes intérieures des sas - Portes 01, 06
deux vantaux vitrés PF 1/2H dim.210*210

1.2 ensembles vitrés 180/210 -
Portes 13, 14, 15, 20, 21, 22, 25, 26, 27
1 vantail vitré PF 1/2H ouvrant 103*204cm
+ 1 fixe 70*210cm

1.3 Porte de recouvrement - Porte 04
Porte de recouvrement PF 1/2H+FP
2 vantaux tiercée vitrée 90+30*204cm

1.4 Porte vitrée 93/204ht
Porte 02, 03, 07, 09,
vitrée PF 1/2H ouvrant 93*204cm

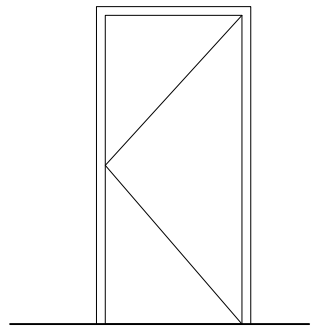
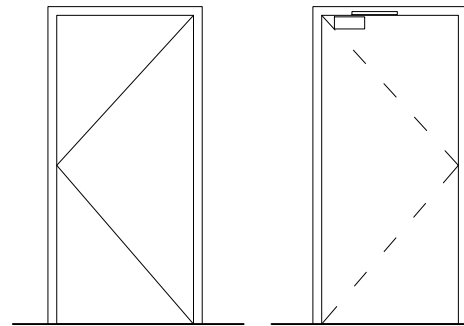
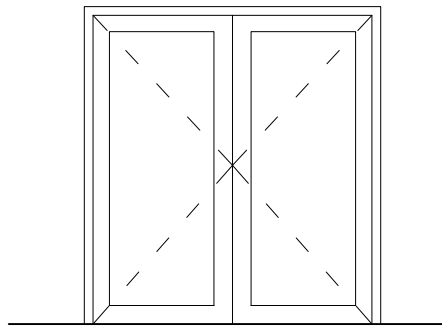
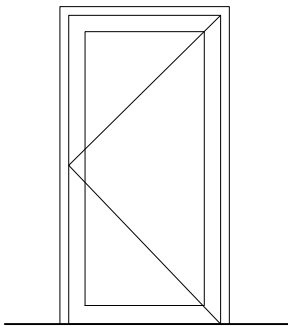
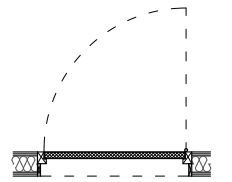
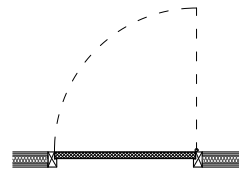
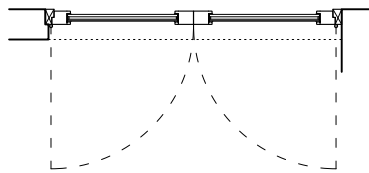
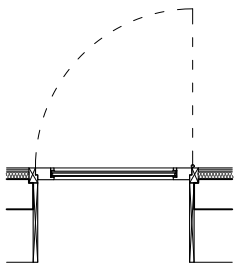

1.5 Porte PF1/2H 103/204cm - Porte 16
1 vantail PF 1/2H vitré ouvrant 103*204cm

1.6 Porte double vitrée - Porte 32
2 vantaux vitrés 2*90/204cm

1.7 Porte CF 1/2h+FP - Portes 05, 28, 29, 30, 31
1 vantail plein ouvrant 93*204cm
CF 1/2H+FP

1.8 Porte pleine acoustique -
Portes 08, 10, 11, 12, 17, 18, 19, 23, 24
1 vantail plein acoustique PF 1/2H
ouvrant 93*204cm

DETAILS-Menuiserie intérieure-PORTES

ECHELLE| 1:50ème

<p>Maître d'ouvrage : Syndicat intercommunal scolaire de Pournoy-La-Grasse</p>	<p>Assistance à la Maîtrise d'Ouvrage : MATEC - Moselle Agence Technique 18, Boulevard Paixhans - 57000 METZ contact@matec57.fr 03 55 94 18 11</p>	<p>Details- Men.Int. Nov.2017</p> <p>DETAIL-Men.Int Portes ech: 1/50ème</p>
<p>Architectes Mandataires : Xavier Géant / Agnès Hausermann studiolada architectes 12, rue Saint Dizier - 54000 NANCY 03 83 33 92 13</p>	<p>Partenaires Maîtrise d'oeuvre : BET structure BARTHES Bois BET fluides/SSI Tecnos BET thermique Terranergie</p>	<p>studiolada a r c h i t e c t e s</p>

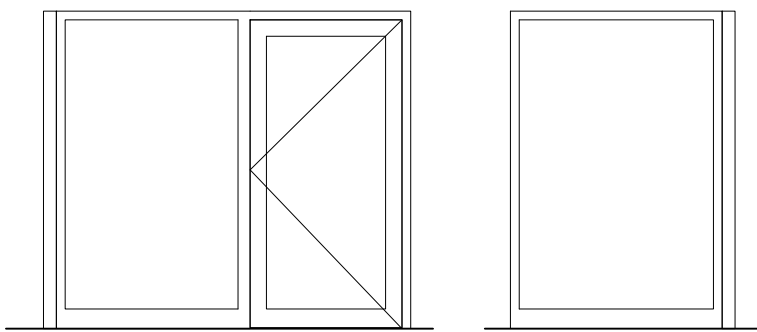
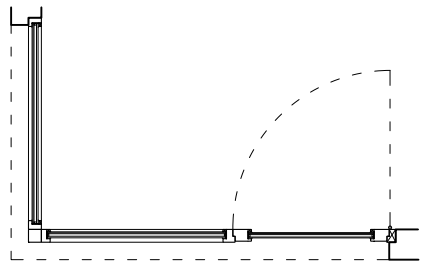

2.1 Ensemble menuisé MI06
Ensemble vitré PF 1/2H
2 fixes 140*210cm ht et 140*210cm
+ porte vitrée ouvrant 103*204cm

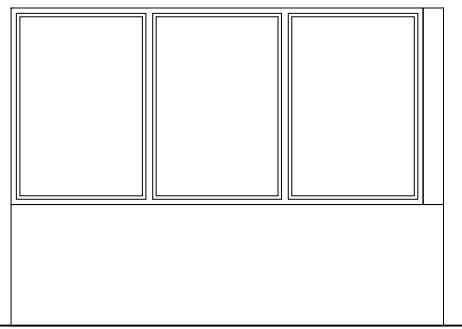

2.2 Ensemble menuisé MI01
Ensemble vitré fixe
PF 1/2H 282*210cm ht

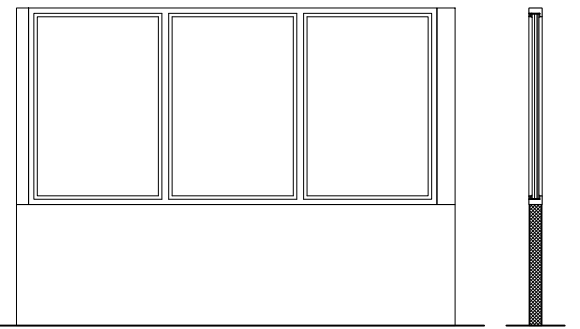

2.3 Ensemble menuisé MI03
Ensemble vitré fixe
PF 1/2H 290*210cm ht

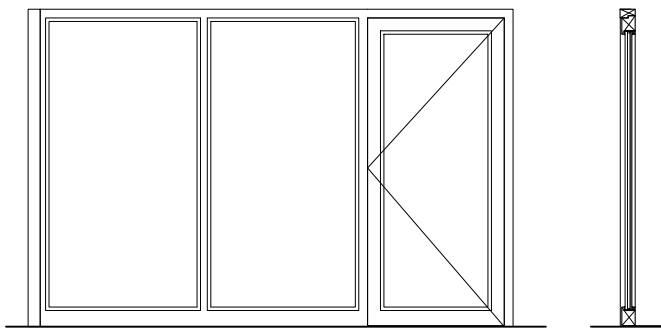
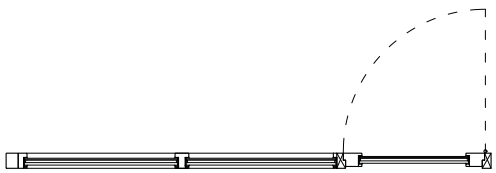

2.4 Ensemble menuisé MI04
Ensemble vitré PF 1/2H
fixe 225*210cm ht + porte vitrée ouvrant 93*204cm

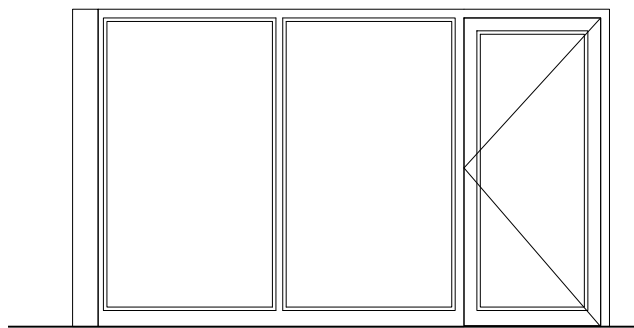

2.5 Ensemble menuisé MI05
Ensemble vitré PF 1/2H
fixe 242*210cm ht + porte vitrée ouvrant 93*204cm

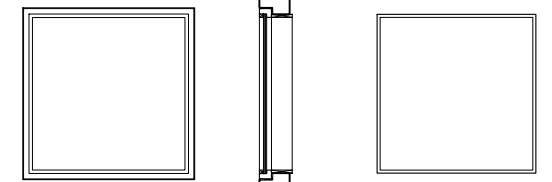

2.6 Châssis vitrés MI07, 08, 09, 10, 11, 12
Châssis vitré fixe
105*105cm

DETAILS-Menuiserie intérieures-Ensembles menuisés

ECHELLE| 1:50ème



<p>Maître d'ouvrage : Syndicat intercommunal scolaire de Pournoy-La-Grasse</p>	<p>Assistance à la Maîtrise d'Ouvrage : MATEC - Moselle Agence Technique 18, Boulevard Paixhans - 57000 METZ contact@matec57.fr 03 55 94 18 11</p>	<p>Details-Men.Int. Menuiseries intérieures Nov.2017 ech: 1/50ème</p>
<p>Architectes Mandataires : Xavier Géant / Agnès Hausermann studiolada architectes 12, rue Saint Dizier - 54000 NANCY 03 83 33 92 13</p>	<p>Partenaires Maîtrise d'oeuvre : BET structure BARTHES Bois BET fluides/SSI Tecnos BET thermique Terranergie</p>	<p>studiolada a r c h i t e c t e s</p>

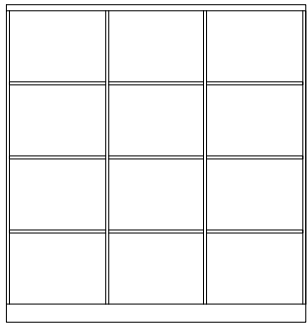
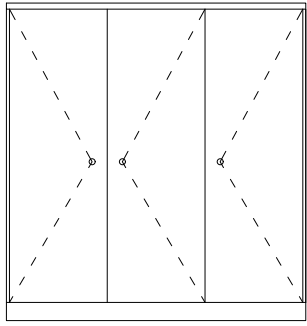
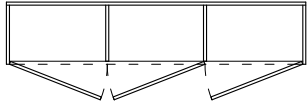

3.1.1 Placards MI16/18/20
Ensemble de dimension 40*190*210cm ht

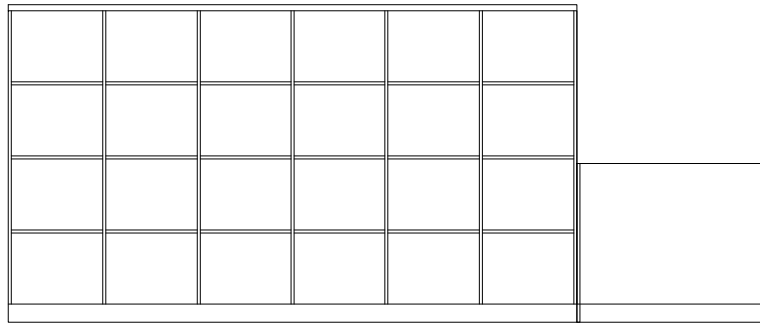
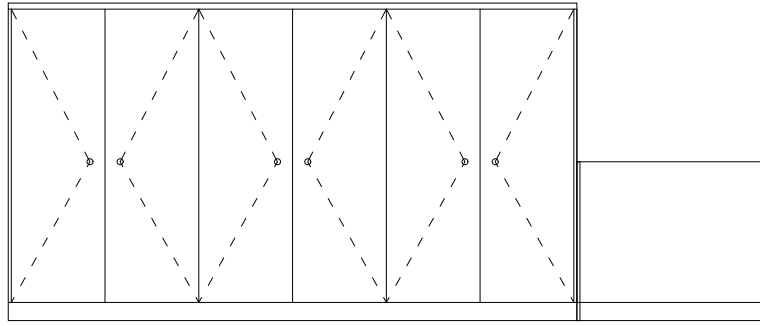
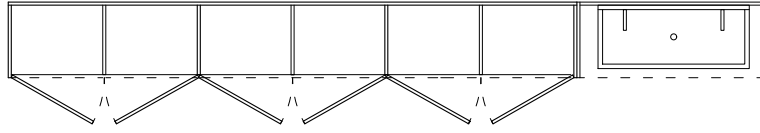

3.1.2 Placards MI17/19/21
Ensemble de dimension 50*376*210cm ht

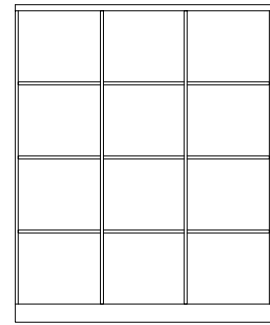
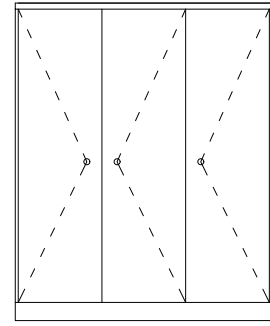
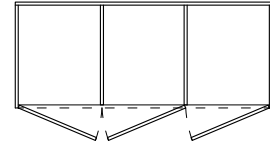

3.1.4 Placard MI14
Ensemble de dimension 70*170*210cm ht

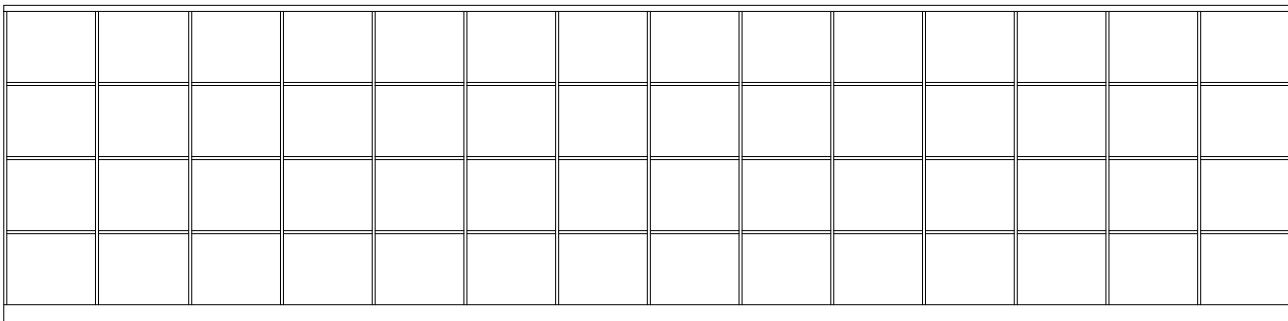
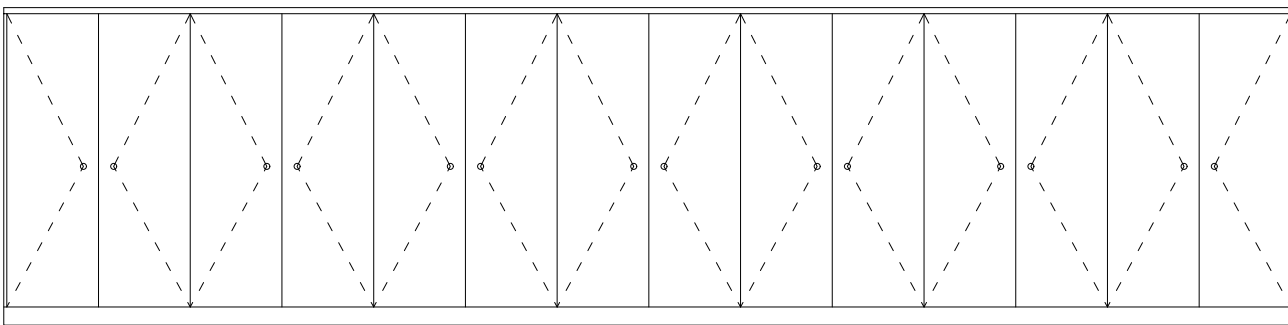
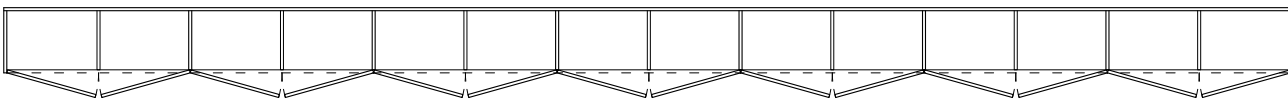

3.1.3 Placard MI22
Ensemble de dimension 44*850*210cm ht

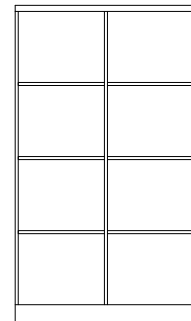
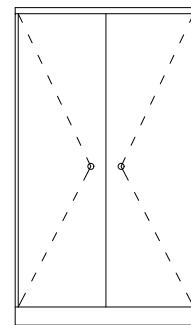
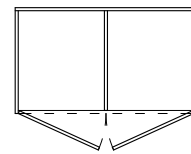

3.1.5 Placard MI15
Ensemble de dimension 70*120*210cm ht

DETAILS-Menuiserie intérieure-Agencement

ECHELLE| 1:50ème | 0 .5 1 1.5 2 2.5M

<p>Maître d'ouvrage : Syndicat intercommunal scolaire de Pournoy-La-Grasse</p>	<p>Assistance à la Maîtrise d'Ouvrage : MATEC - Moselle Agence Technique 18, Boulevard Paixhans - 57000 METZ contact@matec57.fr 03 85 94 18 11</p>	<p>Details- Agencement-1 Nov.2017</p>	<p>DETAIL-Men.Int Agencement ech: 1/50ème</p>
<p>Architectes Mandataires : Xavier Géant / Agnès Hausermann studiolada architectes 12, rue Saint Dizier - 54000 NANCY 03 83 33 92 13</p>	<p>Partenaires Maîtrise d'oeuvre : BET structure BARTHES Bois BET fluides/SSI Tecnos BET thermique Terranergie</p>	<p>studiolada a r c h i t e c t e s</p>	

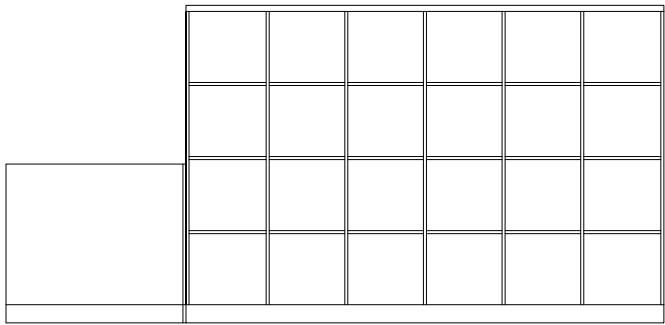
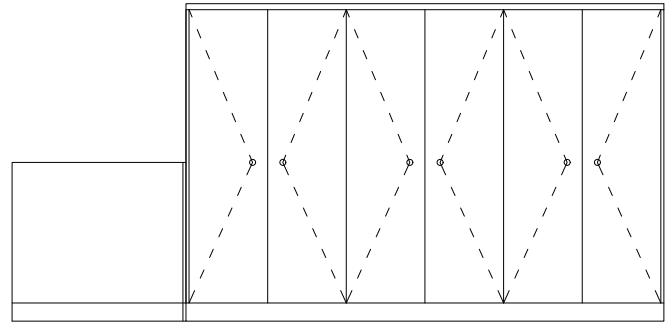
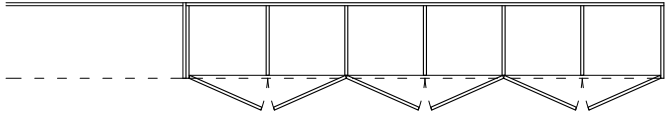

3.2.1 Placards MI25/27/29/32/34
Ensemble de dimension 50*320*210cm ht

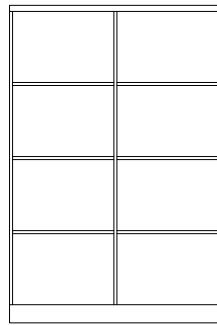
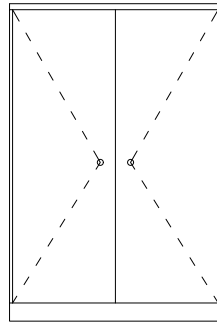
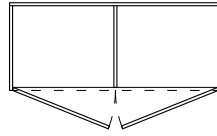

3.2.2 Placards MI24/26/28/31/33
Ensemble de dimension 60*140*210cm ht

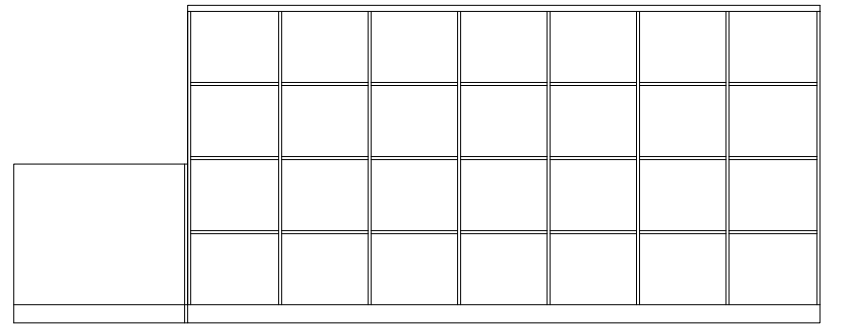
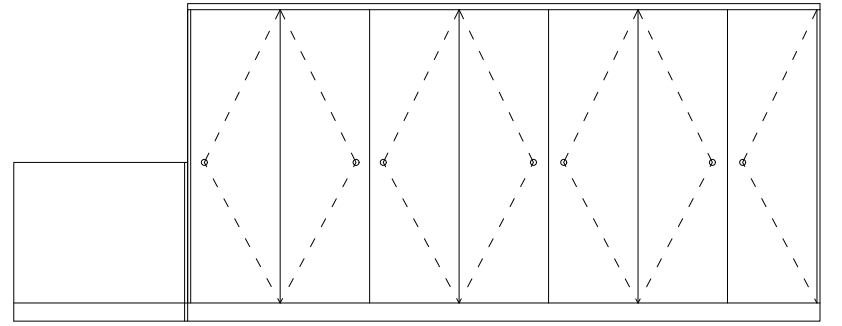
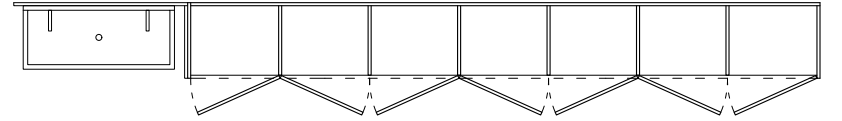

3.2.3 Placard MI30
Ensemble de dimension 50*420*210cm ht

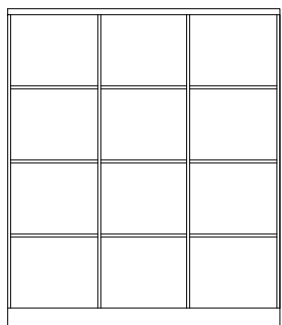
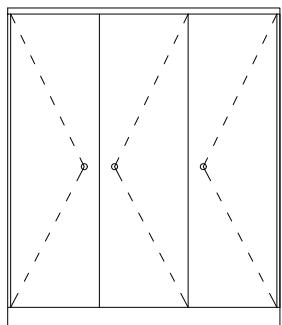
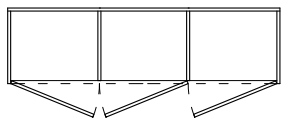

3.2.4 Placard MI35
Ensemble de dimension 40*180*210cm ht

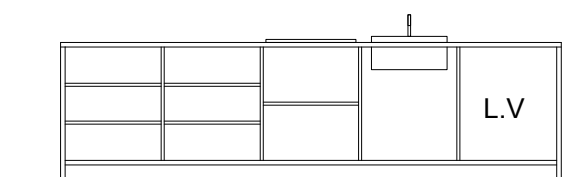
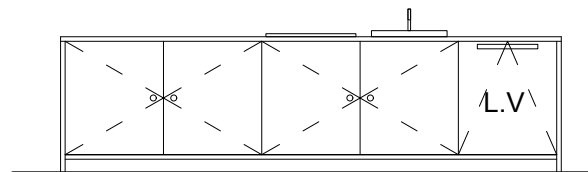
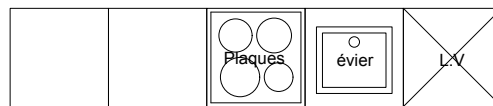

3.3 Meuble de cuisine MI13
Meuble kitchenette

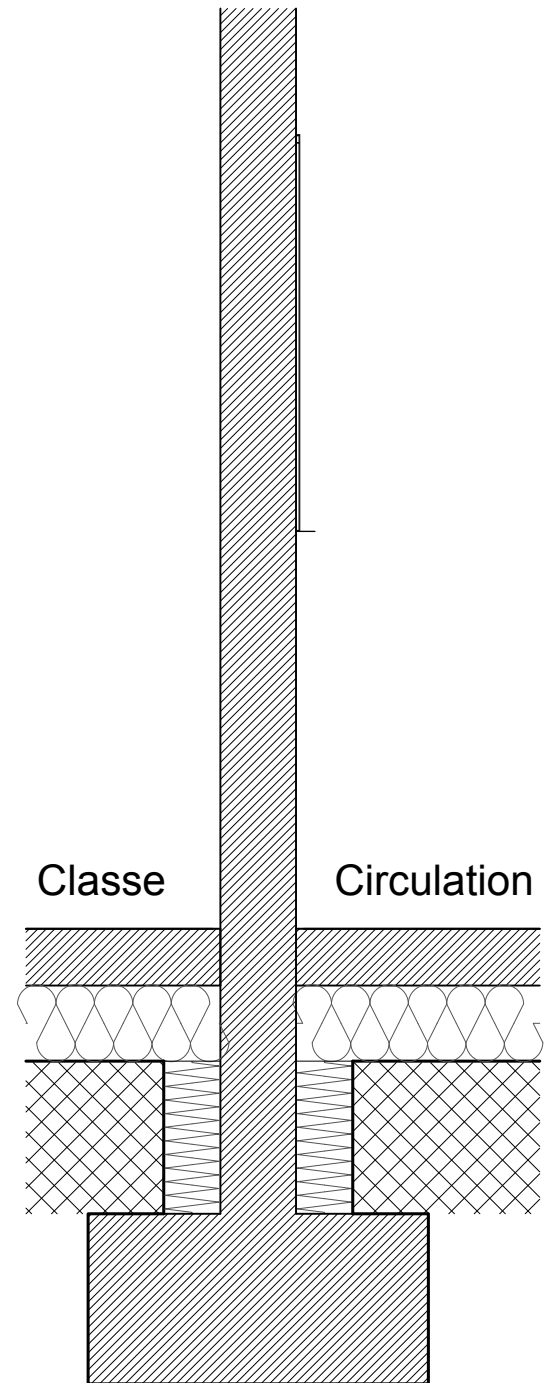
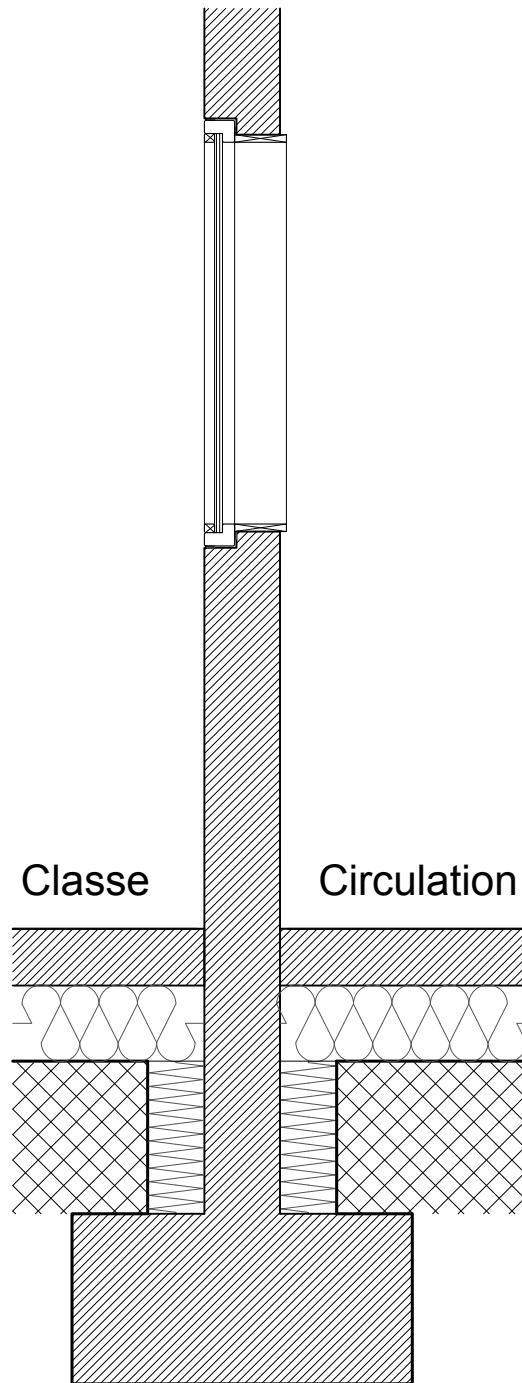
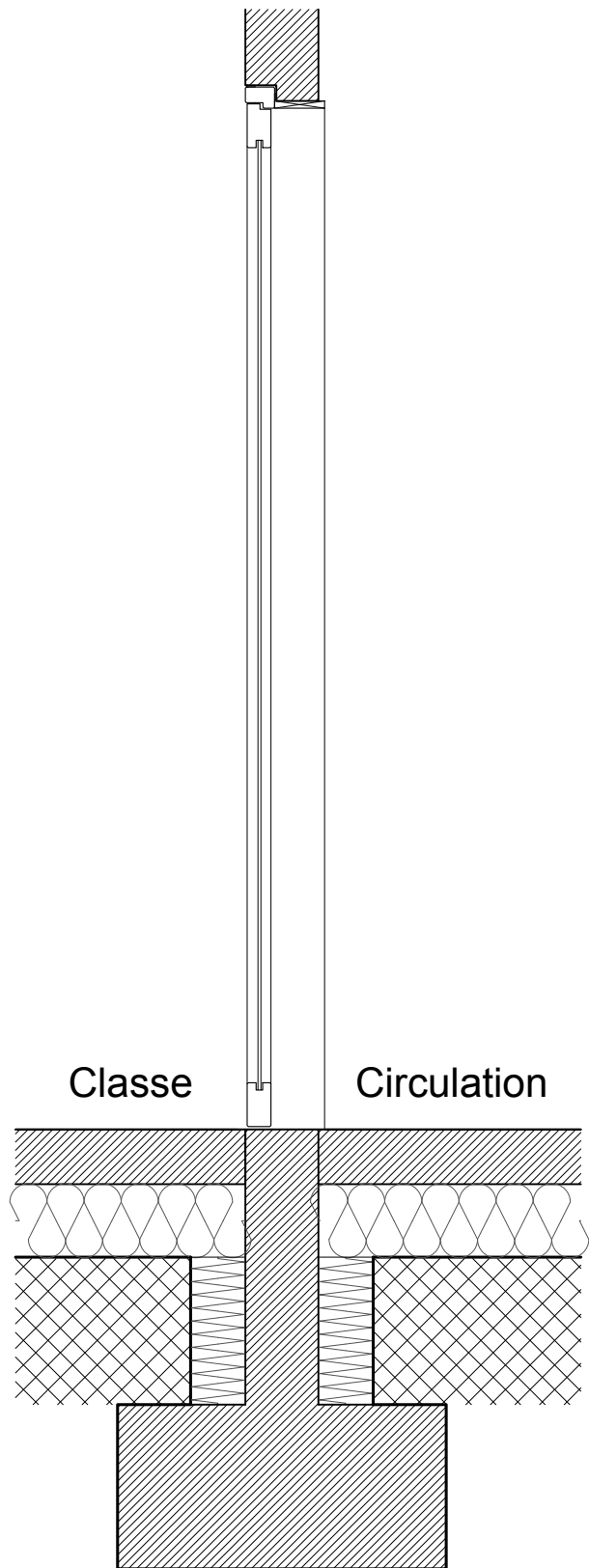
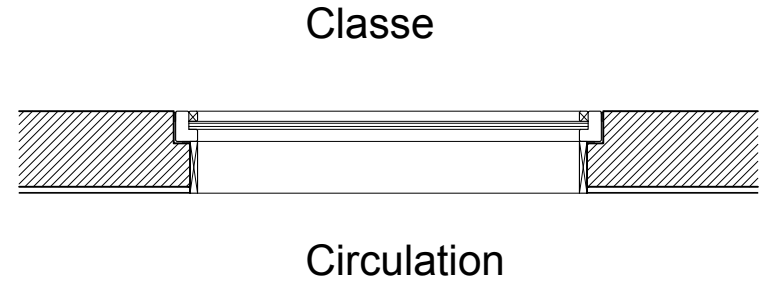
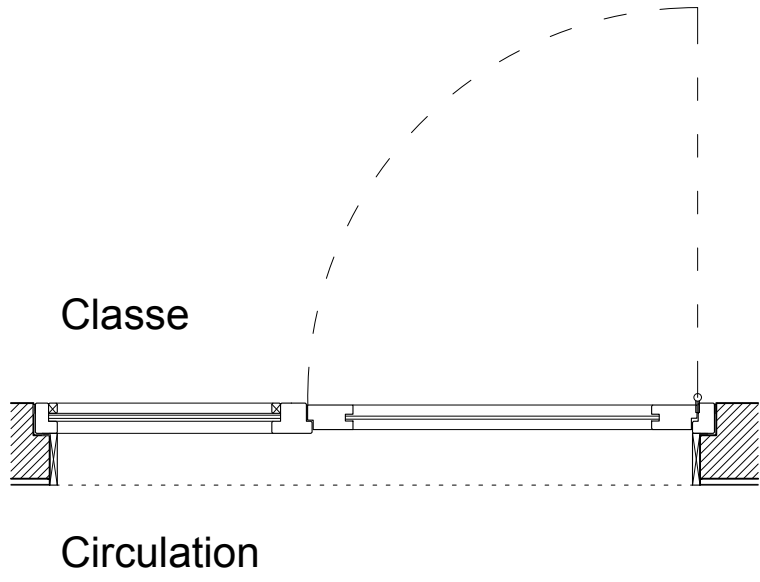

MISE EN OEUVRES DES ENSEMBLES VITRES 'PORTE 13,14,15,20,21,22,25,26,27'

MISE EN OEUVRES DES CHASSIS VITRES FIXE DANS LA CIRCULATION ELEMENTAIRE

DETAILS-Integration des menuiseries intérieures

ECHELLE | 1:20ème



<p>Maître d'ouvrage : Syndicat intercommunal scolaire de Pournoy-La-Grasse</p>	<p>Assistance à la Maîtrise d'Ouvrage : MATEC - Moselle Agence Technique 18, Boulevard Paixhans - 57000 METZ contact@matec57.fr 03 55 94 18 11</p>	<p>Details Nov.2017</p>	<p>DETAIL-Men.Int Intégration des menuiseries ech: 1/20ème</p>
<p>Architectes Mandataires : Xavier Géant / Agnès Hausermann studiolada architectes 12, rue Saint Dizier - 54000 NANCY 03 83 33 92 13</p>	<p>Partenaires Maîtrise d'oeuvre : BET structure BARTHES Bois BET fluides/SSI Tecnos BET thermique Terranergie</p>	<p>studiolada a r c h i t e c t e s</p>	