

N

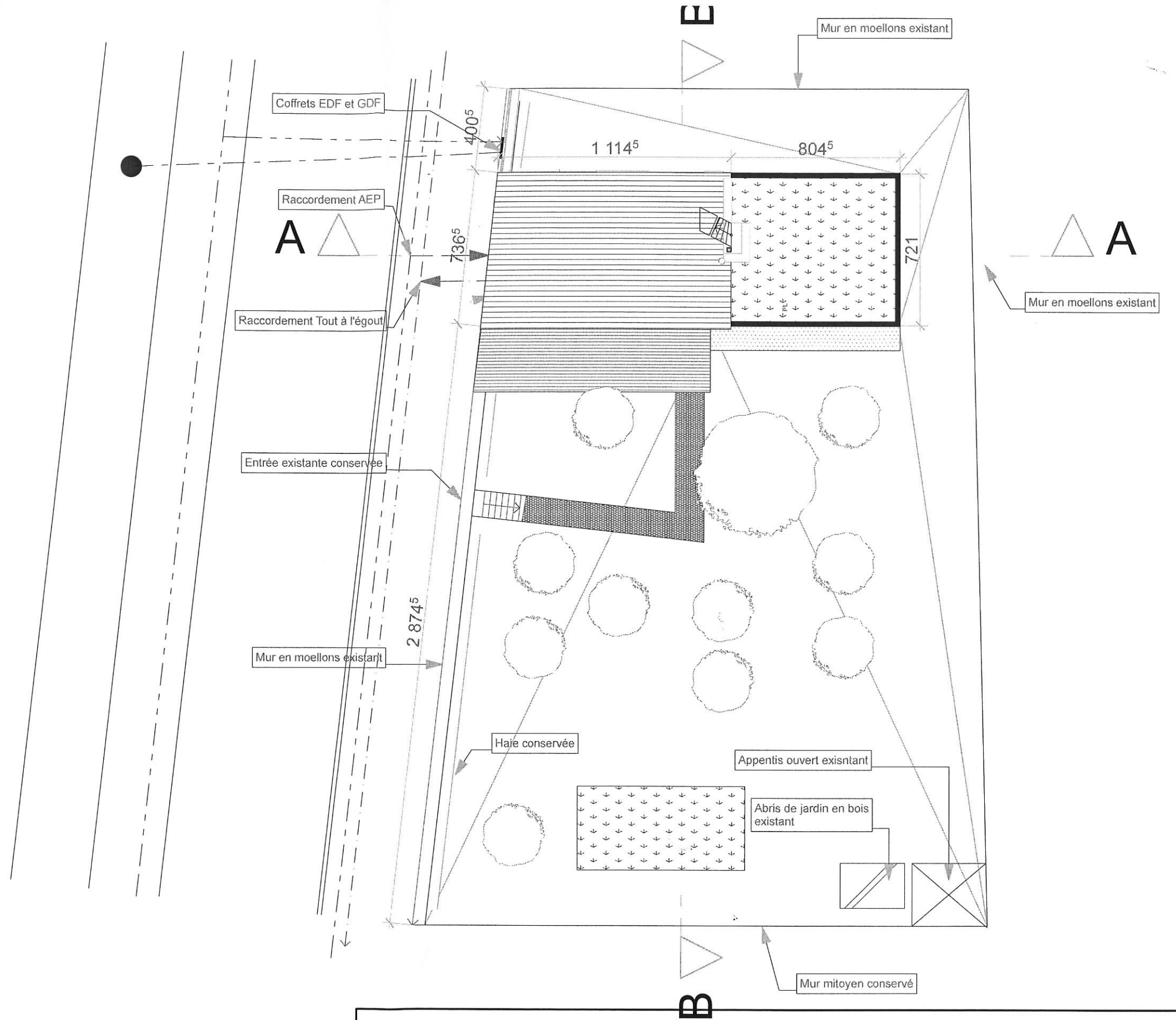
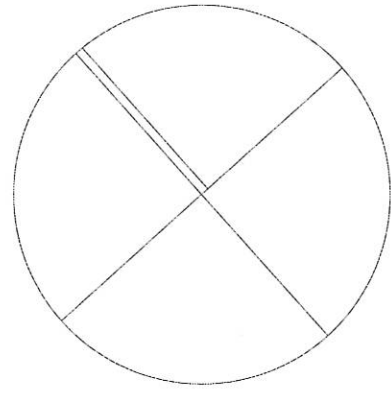

<p>Mme et M. SOUEL Construction d'une maison individuelle en ossature bois Rue de Strasbourg "les pains de seigle" 55500 Ligny en Barrois</p>		
<p>PLAN DE MASSE</p>	<p>01- 3</p>	<p>Date: 20/09/07 Modifications:</p>
<p>Echelle(s): 1:200 DESSIN: J. DEFER</p>	<p>PERMIS</p>	